

HOLDINGS OF THE FLORIDA-CLEVELAND  
LAND AND DEVELOPMENT CO., KNOWN AS:-

# SANTAFE HEIGHTS

BEING THE S.E. 1/4 OF N.E. 1/4 - SECTION 21  
TOWNSHIP 7 SOUTH, RANGE 17 EAST  
COLUMBIA COUNTY - FLORIDA

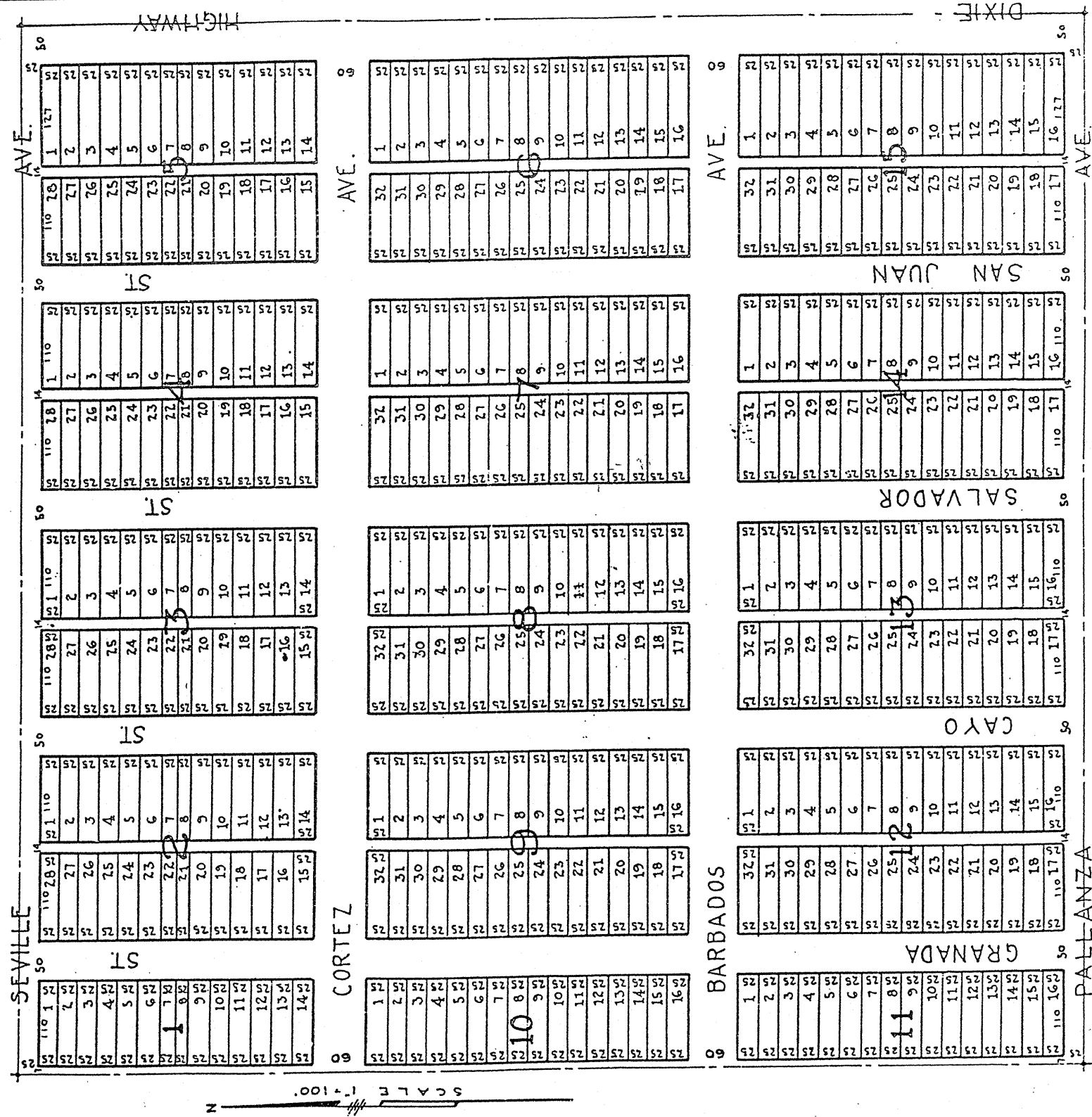

SCALE 1" = 100'

RECORD PLAT - MVD 4/13/25. TRACED IN OFFICE OF C. YOUNG SPRINGER, D.M.G., FLA.

PLAT BOOK  
A PAGE 38